

# Google Chrome sign-in

Wednesday, June 1, 2016 8:35 AM

1. Open Google Chrome browser:



2. Click the "chess pawn" icon in the upper right corner of the window:



3. Click "Sign in to Chrome"

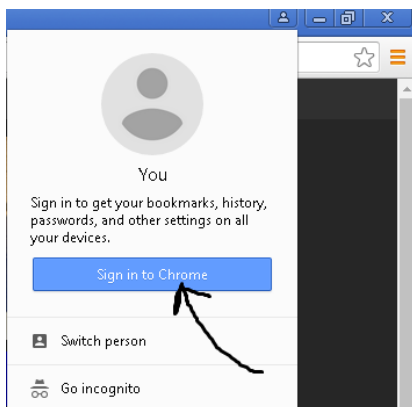

4. Type in your user name, which is the same as your computer or Chromebook login @boe.mono.k12.wv.us, and click "Next"

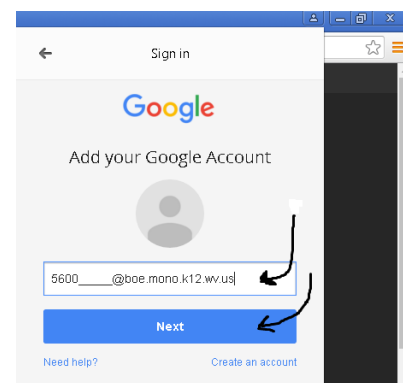

5. Enter your password (the same as a Chromebook or Windows computer) and click "Sign in"

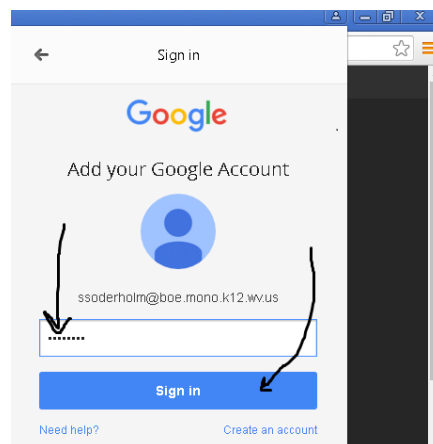

6. On the next window, you **MUS** click "Link data" to access saved passwords, bookmarks, apps & extensions, etc.

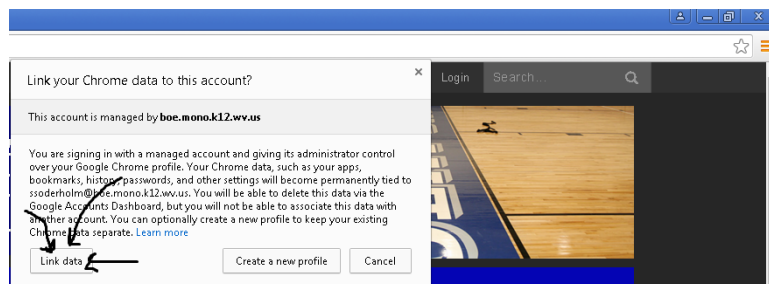

7. You will see your name appear at the top of the window, bookmarks and extensions loading, etc. Access apps (including My Drive files) from the apps launcher on the left end of the bookmark bar.

